



SHIROI BULLETIN

白井宣传

白井宣傳

홍보시로이

広報しろい

May 2018



Holiday of May - 5/3 Kenpo Kinenbi (Constitution Memorial Day)

In memory of the enforcement of post-war new pacifism constitution on May 3, 1947, this day is designated as Constitution Memorial Day.

FROM MAY 1ST INZAI POLICE STATION BRANCH OFFICE OPENS!

(印西警察署白井分庁舎が開庁します)

Open 8:30am ~ 5:15pm ※ except Sat., Sun., national holidays, Year end and new year's day (Dec. 29 ~ Jan. 3)

※ Applications /registrations will be accepted at Inzai Police Station as well. Urgent applications requiring a quick reply should be made at Inzai Police Station.

Inquiries: Inzai Police Station Shiroi Branch Office Tel 498-4228

	Handling duties	Reception time
Traffic matters	Driver's license <ul style="list-style-type: none"> ● Renewal (for excellent and general drivers only) ● Reissue ● Change of items mentioned ● Revocation application ● Issue a certificate of driver's career (application, reissue, change of items mentioned) ※ Administrative disposition of driver's license (return of suspended license, etc.) will be handled at Inzai Police Station (main office).	Mon. ~ Fri. 8:30am ~ 12:00 pm 1:00~ 5:00 pm
	Traffic regulations Application of car depository certificate/issue a mark ※ It will take one day longer to issue than at the main office. Applications for permission of road usage and other permissions/issue (requiring urgent handling) will be accepted only at the main office. ※ Postal applications are not available.	
Lost and found	Report of lost and found items	Mon. ~ Fri.
Trouble and accidents	Report of troubles and accidents/ consultation	8:30am ~5:15pm

FLOOR MAP

(Health and Welfare Center and Shiroy City Hall)

East Building

Main Building

4F

Health and Welfare Center

3F

2F

1F

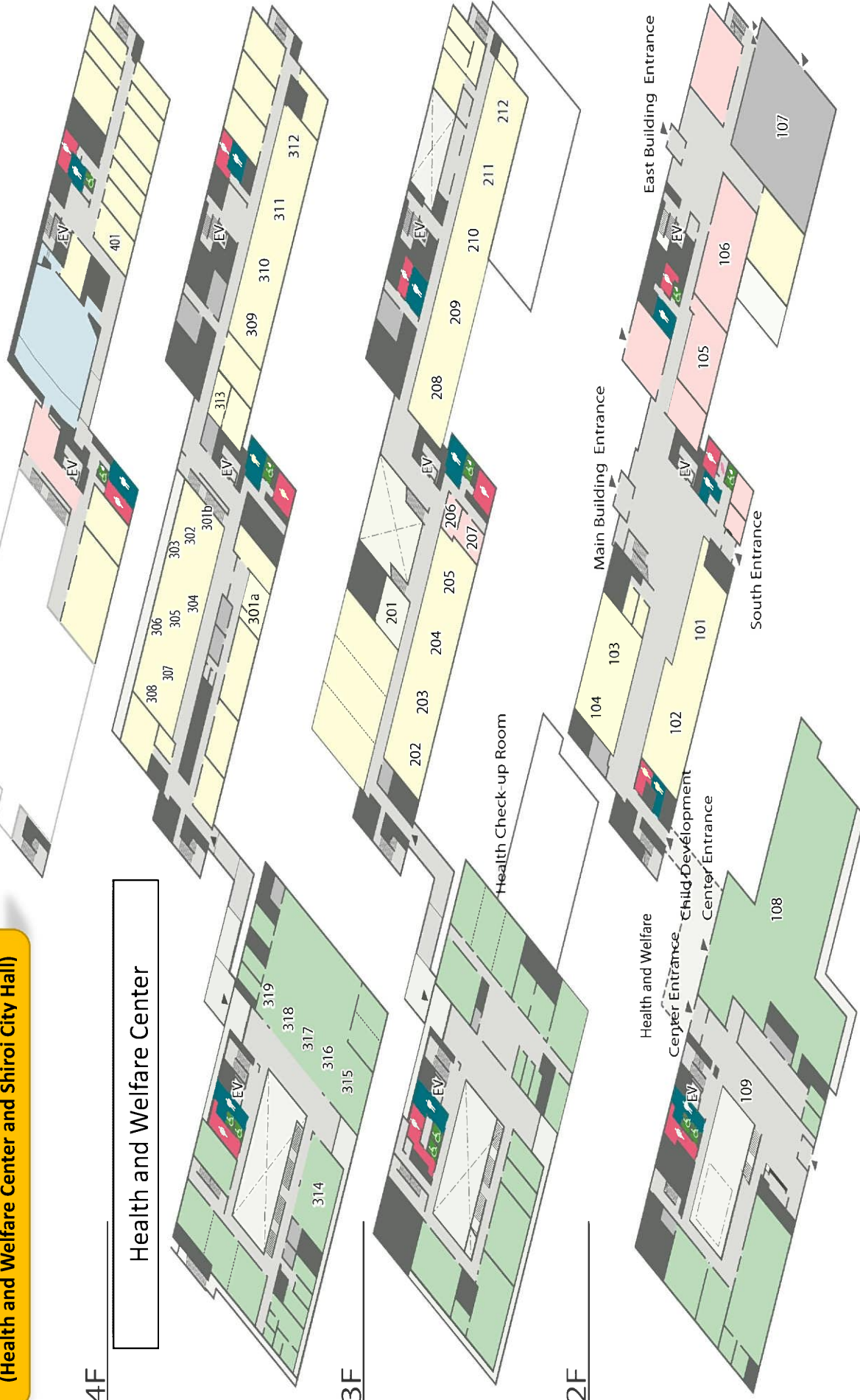

Shirol City Hall Organizational Structure

保健福祉センター Health and Welfare Center				
Floor	No.	JPN.	THE ROMAN LETTERS	ENG.
3階 Third Floor	314	社会福祉協議会 福祉部	Syakai Fukushi Kyogikai Fukushi bu	Social Welfare Council Welfare Department
	315	社会福祉課	Syakai Fukushi ka	Social Welfare Section
	316	障害福祉課	Syogai Fukushi ka	Disability Person's Welfare Section
		健康子ども部	Kenko Kodomo bu	Health and Child Affairs Department
	317	保育課	Hoku ka	Nursery Section
1階 First Floor	318	子育て支援課	Kosodate Shien ka	Child Rearing Support Section
	319	健康課	Kenko ka	Health Section
	108	子ども発達センター	Kodomo Hattatsu Sentā	Child Development Center
	109	福祉部	Fukushi bu	Welfare Department
		地域包括支援センター	Chiki Hokatsu Shien Sentā	Community General Support Center

東庁舎 East Building				
Floor	No.	JPN.	THE ROMAN LETTERS	ENG.
4階 Fourth Floor	401	議事事務局	Gikai Jimukyoku	City Council Secretariat
		教育部	Kyoiku bu	Education Department
	309	教育総務課	Kyoiku Somu ka	Education Affairs Section
	310	生涯学習課	Syogai Gakusyu ka	Lifelong Learning Section
	311	学校政策課	Gakko Saksaku ku	School Policy Section
	312	教育支援課	Kyoiku Shien ka	Education Support Section
	313	監査委員事務局	Kansa In Jimukyoku	Audit Commissioner Secretariat
2階 Second Floor		都市建設部	Toshi Kensetsu bu	City Construction Department
	208	建築宅地課	Kenchiku Takuchi ka	Building Land and Building Guidance Section
	209	都市計画課	Toshi Keikaku ka	City Planning Section
	210	道路課	Doro ku	Road Section
	211	上下水道課	Joge Suido ku	Water Supply and Sewerage Section
		市民環境経済部	Shimin Katsudo Shien bu	Citizen, Environment and Economy Department
1階 First Floor	212	環境課	Kankyo ka	Environment Section
	105	市民活動支援課	Shimin Katsudo Shien ka	Community Activities Support Section
	106	しろい市民まちづくりサポートセンター	Shiroi Shimin Machizukuri Supoto Sentā	Shirol Citizens' Community Development Support Center
	107	自井警察センター (印西警察署分庁舎)	Shiroi Keisatsu Sentā (Izumi Keisatsugyo Banchosha)	Shirol Police Center (Izumi Police Station Shirol Branch Office)

本庁舎 Main Building				
Floor	No.	JPN.	THE ROMAN LETTERS	ENG.
3階 Third Floor		総務部	Somu bu	General Affairs Department
	301a 301b	秘書課	Hisho ka	Secretarial Section
	302	総務課	Somu ka	General Affairs Section
	303	情報管理課	Joho Kanri ka	Information Management Section
	304	行政経営改革課	Gyosei Keiei Keikaku ka	Administration Management Reform Section
	305	管財契約課	Kanzai Keiyaku ka	Property Management and Contract Section
		企画財政部	Kikaku Zaisei bu	Planning and Finance Department
	306	財政課	Zaisei ka	Finance Section
	307	しろいの魅力発信課	Shirol no Miryoku Hassin ka	City Promotion Section
	308	企画政策課	Kikaku Seisaku ka	Planning and Policy Section
2階 Second Floor		総務部	Somu bu	General Affairs Department
	201	危機管理課	Kiki Kanri ka	Crisis Management Section
		企画財政部	Kikaku Zaisei bu	Planning and Finance Department
	202	収税課	Shuizei ka	Tax Collection Section
	203	課税課	Kazei ka	Taxation Section
	204	農業委員会事務局	Nogyo Inikai Jimukyoku	Agricultural Committee Secretariat
		市民環境経済部	Shimin Katsudo Shien bu	Citizen, Environment and Economy Department
1階 First Floor	205	産業振興課	Sangyo Shinko ka	Industry Promotion Section
	206	消費生活センター	Shohi Seikatsu Sentā	Consumer Affairs Consultation Center
	207	無料職業紹介所	Muryo Shokugyo Shokujō	Free Employment Agency
	101	市民課	Shimin ka	Citizens' Affairs Section
		健康子ども部	Kenko Kodomo bu	Health and Child Affairs Department
	102	保険年金課	Hoken Nenkin ka	Insurance and Pension Section
		福祉部	Fukushi bu	Welfare Department
	103	高齢者福祉課	Koroshu Fukushi ka	Elderly Welfare Section
		会計管理者	Kaikai Kanrisha	Accounting Administrator
	104	会計課	Kaikai ka	Accounting Section

Garbage Zero campaign (ごみゼロ運動)

Garbage zero campaign will be held with the nationwide “Reduce garbage/recycle promotion week”.

Your cooperation to clean main and neighborhood streets will be appreciated.

※ More details will be notified from the neighborhood self-governing body.

Date: 27 (Sun) 8:00 ~ 10:00am

Place: all around Shiroy city

Inquiries: Kankyo-ka (Environment Section) ext. 3765

Recycle market (リサイクルマーケット出店者募集)

The City will hold a recycle market to encourage exchanging items by recycling and reducing waste.

Date: 27th (Sun) 10:30 am ~ 3:00 pm (in case of raining, cancelled)

Place: Shiroy Comprehensive Park

Participants: 40 divisions

※ one division per person. If applicants exceed the number, participants and their places will be decided by lot.

Eligible participants: Those who live in Shiroy and are not sales workers.

Items that cannot be sold: food and drinks (except canned food), pets, items that are prohibited for sale by law

Charge: free

For inquiries and applications: Send or bring a post card to *Kankyo-ka* or Environment Section (ext. 3765) by 17th (Thu) with the following items specified: "Want to join the Recycle Market", your post code, address, name, sex, age, phone number, and recycling items.

※ If you would like to participate with a stall close to your friends, please specify it clearly in writing when you apply.

Free Employment Agency (無料職業紹介所)

The city of Shiroy runs a free employment agency for the city and its neighboring cities.

We accept and refer employment to applicants seeking permanent and part-time jobs. Please do not hesitate to avail it. Registration is required for those who are looking for a job. In addition, employment consultation and introduction at the free employment agency is considered a job seeking activity for employment insurance certificate of unemployed.

※ We also accept job offer information from companies so please contact us.

Date and time: Monday - Friday 9:00am – 5:00pm (information desk: 9:00am – 12:00pm, 1:00pm – 4:00pm)

Place: 2F Shiroy City Hall Main Building

Covered cities: Shiroy City · Inzai City · Kashiwa City · Kamagaya City · Funabashi City · Yachiyo City · Abiko City

For inquiries, contact: *Muryo Shokugyo Shokai-Sho* or Free Employment Agency at ext. 3203

“Nationwide Information Notification Drill” by Disaster Protection City Radio Announcement

(防災行政無線で「全国一斉情報伝達訓練」を行います)

“J-alert”, an immediate alert notification system throughout the country when an earthquake or military attack occurs, will notify you of emergency information by disaster city radio. In order to confirm the system works right, the nationwide broadcasting drill will be held.

On the day, the following information will be notified by the PA in the city. Your understanding and co-operation will be appreciated.

Broadcasting date: 16th (Wed) 11:00 am

Information: “This is J-alert test” (repeating 3 times),” This is Disaster Protection Shiroy,”

※ The test may be cancelled according to the weather or actual disasters.

Inquiries: *Kiki-kanri-ka* or Crisis Management Section ext. 3294 ・ 5

A death from the traffic accident occurred in the City (市内で交通死亡事故が発生)

A seven-year old boy died in a traffic accident, hit by a small car when he was walking along the street in Shimizuguchi, on March 30th at 5:00 pm.

There were 3 traffic accident deaths in FY 2017, and 1 until March 2018 (one more than at the same time last year).

New FY has just started, and now is the time that more traffic accidents may possibly occur. Let's pay attention and protect children and seniors from traffic accidents with drivers, families and communities.

Inquiries: Shimin-katsudou Sien-ka or Community Activities Support Section ext. 3616

Crimes ・ Traffic accidents ・ Fire reports in Shiroy City (February)

	Occurrence situation	Number of cases	FY 2018 total
Crimes	Total of crime cases	34	57
	Telephone fraud	0	0
	The amount of damage by telephone fraud	0 yen	0 yen
Traffic accidents	Accidents resulting in injury or death	11	29
	Number of death	0	0
	Bicycle accidents	1	9
Fire	Fire	3	6
	Calls for an ambulance	218	467
	Rescue	3	6

Travelling Police Box will open (移動交番)

Travelling police box schedule in May is as follows

Date and Place: 1st (Tue), 10:00~11:30 am, 20th (Sun) 2:00 ~ 3:30 pm, 28th (Mon), 10:00am ~ 12:00 pm, Mini Stop Shiroy Kawarako store, 2nd (Wed), 25th (Fri), 10:00am ~ 12:00pm Lawson Chiba Shiroy store (Nihi-shiroy), 10th (Thu), 2:00 ~ 4:00 pm, 30th (Wed), 2:00 ~ 3:30 pm Shiroy Athletic Park

※ It may be changed according to an accident or crime.

Inquiries: Inzai Police Station Tel 0476-42-0110

Radioactive substance inspection on food (食品などの放射性物質検査)

The city is conducting radioactive substance inspection on food consumed at home and elsewhere. Bringing in items for inspection is from 8:30am to 11:00am on inspection days, Tuesdays and Thursdays (or the next day in case the city hall is closed due to a holiday). Application in advance is required to qualify your items for inspection.

For accurate food inspection, finely cut the part to be eaten about 300 grams or more, put in a plastic bag and bring. In case of drinks, please bring 2 liters or more in a plastic bottle.

Inspection results will be notified from *Sangyo Shinko-ka* or Industry Promotion Section on Thursday for Tuesday inspection or Monday for Thursday inspection. In case the city hall is closed on either Thursday or Monday due to a holiday, results will be released the next day, respectively.

※ Should you wish to get the result by mail, kindly bring 82yen stamp.

Target: Shiroy city residents and city contractors

Items for inspection: Food and drinks consumed at home and business establishments

※ Soil is excluded.

Inspection cost: Free

For requests and inquiries, visit or call: *Sangyo Shinko-ka* or Industry Promotion Section at ext. 3241

Participants for International Goodwill Mini Soccer Tournament (国際親善ミニサッカー大会参加者募集)

We will hold "International Goodwill Mini Soccer Tournament" through the planning and operation of International Friendship Association of Shiroy (IFAS) in order to interact and deepen friendship with foreigners living in the city and its neighboring areas.

Would you like to make international exchanges on natural turf pitch with foreigners from Brazil, Peru and the like?

Date and Time: May 20th (Sun), 8:30am – 3:30pm (Canceled only in case of heavy rain)

Place: Shiroy Athletic Park

Target: Individuals or teams of 6 or more 12 teams (We will do a lottery in case of large number of applicants.)

Game Format: 6-person system with a pitch of 40 x 30 meters

Entrance Fee: 2,000 yen per person, 12,000 yen per team

Application: For individual application, please provide your name, address and telephone number or email address. For team application, please provide your team name and name, address and telephone number or email address of your representative. Kindly call or fax International Friendship Association of Shiroy (IFAS) until May 7th (Mon).

You may call Mr. Hayashi at 090-3497-6959 or fax to 497-3040.

For inquiries, contact: International Friendship Association of Shiroy (IFAS) at 497-3040 and *Kikaku Seisaku-ka* or Planning and Policy Section at ext. 3355

Would you like to utilize housing subsidies? (住宅などの補助金を活用しませんか)

The city is granting various subsidies for improvement and repair of houses. Certain conditions must be met in order to qualify for the subsidy. Application is occasionally necessary before placing your order for construction.

① Assistance in house purchase expenses - assistance to live with parents or live near their parents

We grant subsidies to young generation who want to move from another city to Shiroy city and purchase a house to live with parents or live near their parents.

Subsidy Target / Maximum Amount

- Purchasing a house or building a new house with a floor area of 50m² or more—400,000 yen
 - Adding 30m² or more to the floor area of your house – 300,000 yen
 - Renovating your house which costs 200,000 yen or more— 100,000 yen
 - ※ If there are children who are junior high school students and below, we will grant additional 100,000 yen.
- ② Partial assistance for housing renovation expenses
- We will subsidize a part of the expenses for those who ask a city contractor (corporation with its head office in the city or an individual proprietor) to do the renovation. The subsidy rate is 10% (maximum of 100,000 yen) of the expenses with construction cost of 200,000 yen or more.
- ※ Assistance is given only once per housing in a fiscal year.

For inquiries, contact: *Shiroy-shi Shoko-kai* or The City Commerce and Industry Chamber at 492-0721

③ Partial assistance for asbestos analysis and removal work cost

"Asbestos spray material" may have been used to steel frames or reinforced concrete buildings built between 1955 and 1988.

Target for Analysis: Analytical research expenses of buildings that may be subjected to asbestos spray materials.

Target for Removal Work Assistance: Removal fee for buildings with asbestos spray materials confirmed through the analysis.

Please inquire to us regarding the limit of subsidy grant.

④ Partial assistance for seismic diagnosis of houses and repair work cost

We will subsidize a part of cost for seismic diagnosis and repair work of detached houses and condominiums constructed before May 1981.

Subsidy Target / Maximum Amount

For detached houses, 70,000 yen for seismic diagnosis and 500,000 yen for repair work

- ◆ For condominiums, please inquire about seismic diagnosis and maximum amount of subsidy.

Please contact us for more details regarding subsidies.

※ Applications for ⊖ and ⊖ will be accepted from Thursday, May 10, and will end as soon as the budget runs out.

For applications and inquiries: visit *Kenchiku Takuchi-ka* or Building Land and Building Guidance Section, or call at ext. 3714 · 5

LECTURE FOR MATERNITIES AND BABIES (マタニティ&ベビー向け講座)

Expectant Fathers and Mothers School (プレ☆パパママスクール)

Would you like to learn about childbirth and child rearing together? With fun learning about childcare, it will help you prepare for the coming of your baby.

Date and time, contents, things to bring as shown in the table below.

Place: Health and Welfare Center

Target: expectant mothers (in about 6-9 months of pregnancy) and their families
18 families (on a first-come, first-served basis)

※ Women who already have given birth can also join.

Childcare: Available (application is required a week in advance of each lecture)

TIME	CONTENTS	THINGS TO BRING
20 TH (Sun) 10:00am-12:15pm (reception: 9:45am)	A lecture on the importance of family support in childbirth, pregnancy, simulated fetal movement experience, bathing, carrying a baby experience and pregnancy yoga.	a mother-and-baby notebook, writing materials
23 rd (Wed) 10:00am-12:15pm (reception: 9:45am)	“What should I do when my baby is crying?” A lecture on how to spend time with your baby after giving birth, meals for mothers and babies, and teeth of mothers and babies. There is also a talking session with experienced mothers and their babies, and interactive time while eating <i>shokuiku-bento</i> .	a mother-and-baby notebook, writing materials, 500 yen per person for <i>shoku-bento</i>

For applications and inquiries, contact: *Kenko-ka* or Health Section at 497-3495, or apply through “Chiba online application service” of Shiroy (2018 Lecture for Maternities and Babies application form - 平成 30 年度 マタニティ&ベビー向け講座申し込み).

※ Please accomplish your online application a week before the lecture.

Baby Salon“IPPO IPPO” (ベビーサロン「いっぽいっぽ」)

It is a place where parents who are raising children and their children can participate and enjoy having a conversation. We will also introduce plays or games for parents and children to enjoy. Would you like to expand your circle of parent friends?

※ Advanced reservation is unnecessary, entrance fee is free

Date and Time: 23rd (Wed) 10:00am – 11:30am (reception: 9:45am)

Place: Health and Welfare Center

Target: newborn babies up to 6-months old and their parents

For inquiries, contact: *Kenko-ka* or Health Section at 497-3495

Let's cooperate in preventing secondhand smoke (受動喫煙の防止にご協力を)

Secondhand smoke impact on health

Even if you do not smoke cigarettes, breathing in smoke from cigarettes or smoke from the person who smokes cigarettes is called secondhand smoking. Tobacco smoke contains many harmful substances and affects not only the health of the smoker but also the health of the people around. Let's eliminate "unwanted secondhand smoke" for you and the important people to you.

Secondhand smoking (effect to secondhand smokers)

Discomfort due to odor, stroke, ischemic heart disease, lung cancer, sudden infant death syndrome (SIDS), and childhood asthma.

Efforts on Secondhand Smoking Prevention

Smoke-free in the entire premises of public facilities

The City, after receiving notice on secondhand smoking prevention from the Ministry of Health, Labor and Welfare, has implemented secondhand smoking prevention measures through "Shiroi Health Plan (2nd Term)", and from FY2017 to FY2019, the entire premises of the following facilities will be smoke-free.

No Smoking premises start date and implemented facilities

April 1, 2017	Elementary, junior high schools, and Health and Welfare Center
April 1, 2018	Disabled People's Support Center
May 1, 2018	Shiroi Culture Community Center, each Center, Agricultural Center, School Lunch Preparation Center, Shiroi Athletic Park, and Public Pool.
May 7, 2018	Shiroi City Hall
2019	Elderly Employment Support Center, Shiroi Comprehensive Park, Nakakido Park, Minamiyama Park, Nanatsugi Dai-Ichi Park, Nanatsugi Dai-Ni Park, and Toyoichi Park.

For inquiries, contact: *Kenko-ka* or Health Section at 497-3494

Emergency Medical Treatment for Children

On holidays and at night (休日、夜間の小児救急診療)

First-aid treatment for children 15 years and younger, of sudden fever or stomach ache is available at Inba District Emergency Medical Clinic for children. Please call before coming to have the treatment.

Time: Mon. ~ Sat. 7:00 pm ~ 5:45 am next morning Sun. national holidays, year end and new year days
9:00 am ~ 4:45 pm, 7:00 pm ~ 5:45 am next morning

Place: Inba-shigun Shoni Shoki Kyubyo Shinryojo, Inba District Emergency Medical Clinic for Children (Sakura city, Health Management Center)

Inquiries: Inba District Emergency Medical Clinic for Children Tel 043-485-3355 (during open hours)

Telephone consultation for emergency children's illness (こども救急電話相談)

You can have consultation by telephone when your child gets sick on holidays or at night. A nurse will answer your questions and if it's necessary will forward to contact pediatrician.

Time: 7:00 pm~ 6:00 am next morning

Push phone and mobile phone # 8000

Dial phone (if not able to call # 8000, 043-242-9939)

Inquiries: *Kenko-ka* or Health Section Tel 497-3495

SHIROI COMMUNITY CULTURE CENTER**Culture Hall**

Tel 492-1121

Date	Hall		Open	Charge	Information
13 (Sun)	Nashi-bo	Piano concert	1:30 pm	Free	Murakawa 492-9130
	Kaori	Piano concert	1:30 pm		Kumada 090-2758-4036
19 (Sat)	Kaori	Traveling randoseru (satchel) shop	10:00am		Kandaya Bag factory 0120-310-111
20 (Sun)	Kaori	Home ethic lecture	1:30 pm	¥ 1,000	Home ethic Konishi 491-6415
26 (Sat)	Nashi-bo	Seven colors concert ~6 chorus groups performance~	2:00 pm	Free	Tate 492-3384
27 (Sun)	Kaori	Petit concert for adults	1:00 pm	Free	Morikawa 090-2567-2694

※ Programs may be cancelled or postponed according to the sponsors.

Local Exhibitions Hall

Tel 492-1124

Program	Content	Time	Charge
"History of Shiroy" regular exhibition	From ancient to modern times-history of Shiroy	Tue. ~ Sun. 9:00am ~ 5:00 pm	Free
Exhibition of repaired old writings	Exhibition of old documents which show the relation between old Kyoto village and its load	From 3 (national holiday) Tue. ~ Sun. 9:00am ~ 5:00 pm	

Library

Tel 492-1122

※ open 9:30 am~ 7:00 pm on Tue ~ Sat. 9:30 am~ 5:00 pm on Sun.

Item	Date	Program	Participant	Place
Story telling event	2, 9, 16, 23, 30 (Wed) 3:30 pm~	Picture book reading	Children who can listen to the story alone	Story telling room
Child and parent story telling	23 (Wed) 11:00 am~	Child song, picture book reading	Pre-school age children and parents in Shiroy	

※ Closed on 31 (Thu) for arranging books in order.

Library exhibition corner (April ~ May)

“Narita Airport” ~ the 40th anniversary of opening~

Narita Airport will celebrate its 40th anniversary of opening this May. It is the main gateway of Japan that one hundred thousand people use each day. The documents on the history of the airport, airplanes and workers will be exhibited.

※ There will be exhibitions of seasonal or eventual books at the library exhibition corner.

The library study room will be available again

From 12th (Sat), the study room which has been closed according to the city office building reconstruction work, will be available. Please see the library website for the schedule of the study room, as sometimes it will be closed in some events.

Planetarium

Tel 492-1125

Item	Program	Date	Charge
Kids show	Aim! Mars master (45 min)	Sun. national holidays 11:30 am On 6 th , different program	Shiroi residents Adults ¥ 280 High school students and younger ¥ 100
Regular show	Four seasons in Hokuso, Pears and stars (45min)	Sat. Sun, national holidays 1:30 pm,	Non Shiroi residents Adults ¥340 High school students and younger ¥160 Sold from 30 minutes before the show
	Astronomy museum The Great Bear	Sat. Sun, holidays 3:00 pm	
GW last day kids event	“Starry sky rhythm” participating program for a child and parent	6 (Sun) 11:00 am, 1:30 pm	
Platinum hour (for seniors)	Planetarium story with familiar music “Mars” (45min)	10 (Thu), 12 (Sat) 11:30am ~12:15pm	Shiroi residents Adults ¥ 280 Non Shiroi residents Adults ¥340 Sold from 11:00am
Singing planetarium (for adults)	Let’s sing Showa songs with live performance in the dome. Star explanation will be also given. Performers; clarinet & keyboard “Yuharu”	24 (Thu) 11:30am ~ 12:20 pm	
Astronomy lecture for adults (6 times in all)	The 2 nd time “ What is Mars like?” (reservation necessary by the day before)	17 (Thu) 11:00 am ~ 12:00 pm	First 30 persons Shiroi residents ¥ 280 Non-shiroi residents ¥ 340
Star watching in the day time	Observe the surface of the Sun (in case of bad weather, cancelled)	19 (Sat) 11:30am ~ 1:30 pm	Free
Star watching event	After the lecture of stars in the dome, go out to observe the moon, Venus, Jupiter, and so on. (in case of bad weather, only the lecture will be given)	19 (Sat) 7:30~ 8:45 pm Reception from 7:10 pm	Adults ¥200 Free for high school students and younger ※ Hiyoko planetarium
Hiyoko planetarium	Star story telling for children who watch the planetarium for the first time (30 min)	23 (Wed), 26 (Sat) 11:30am~ 12:00 pm	Sold from 11:00 am

Health Check

Kenko-ka (Health Section) Tel 497-3494

Date	Reception time	Place
11 (Fri)	11:00 am ~ 12:30 pm	Fuji Center
21 (Mon)	10:00 ~ 11:30 am	Health and Welfare Center

Citizens of all ages are welcome. Public health nurses and nurses will give health consultations. Health checkups such as blood pressure checks are available too. * Telephone consultations are also available. ※ On 19 (Mon), children’s height and weight can be measured, and nutrition consultation by a dietitian is available as well.

Children Health Check

Kenko-ka (Health Section) Tel 497-3495



Date	Place	Reception time	Person under the Category
Consultation for 4 month-old child care			
8 (Tue)	Health Center	9:30~10:00 am	Children born in December 2017 will receive notification
18 (Fri)		1:15 ~ 1:45 pm	
Class for baby meals			
9 (Wed)	Health Center	9:45 ~ 10:00 am	Children born in July 2017 will receive notification
Health Check-up for 1 year and 6 months old children			
15 (Tue)	Health Center	1:15~1:45 pm	Children born in October 2016 will receive notification
25 (Fri)			
Dental check-up for 2-year-old children			
16 (Wed)	Health Center	1:15 ~ 1:45 pm	Children born in November 2015 will receive notification
Health check-up for 3 year-old children			
11 (Fri)	Health Center	1:15~1:45 pm	Children born in November 2014 will receive notification.
22 (Tue)			
Health Center is on the 2 nd floor in Health and Welfare Center. If you don't receive notification, please contact the Health Center			

Japanese Class for Foreign Residents

がいにくじん にほんごきょうしつ
(外国人のための日本語教室)

Time Date: Every Friday from 10:00am till noon

Place: Shiroy Ekimae Center

Participants: Foreign residents or those working in Shiroy City

Lesson fee: ¥1,000

Instructor: International Friendship Association of Shiroy

Inquiries and applications: Mr. Yoshida Tel. 047-491-0791

Shiroy City Advisory Service for Foreign Residents

しらいしがいにくじんそうだんまどぐち
(白井市外国人相談窓口)

Shiroy City operates an advisory service to help foreign residents living within Shiroy City solve questions and obtain information related to daily life, city administration, facilities etc.

Reservation by telephone is necessary. (Phone: 492-1111 extension 3354)

Language: English (Other languages could be available)

Date and Time: Will be decided when you reserve by telephone

Published by Shiroy City, Kikaku-Seisaku-ka (Policy and Planning Section)

1123 Fuku, Shiroy-shi, Chiba-ken, 270-1492 Japan

Phone: 047-492-1111 x3354 Fax: 047-491-3510

<http://city.shiroy.chiba.jp/> e-mail:kikaku-seisaku@city.shiroy.chiba.jp
